

# Hide and Seek

Secret away a surprise for your recipients with these interactive designs



Flex your crafty muscles and have a go at this entertaining project by Claire Richards. Interactive cards are always a treat and a popular choice with cardmakers, as there are special stamps and dies available to help build them. Cards with pull tab sliders are fun to make and even more so when there's a hidden element waiting to surprise the recipient. What a great way to celebrate a special occasion, and a card you'll want to make again and again!



## We used...

- \* Stamps: Lawn Fawn Fairy Friends, Oh Gnome, Bannertastic
- \* Dies: Lawn Fawn Let's Toast Pull Tab Add-On, Flower Border, Grassy Border
- \* Stencil, Carta Bella Wander & Find
- \* Patterned papers, Lawn Fawn Spring Fling
- \* Ink-pads: Ranger Distress Oxide Mowed Lawn, Twisted Citron, Dusty Concord, Shaded Lilac, Festive Berries, Spun Sugar; black, green, pink, purple, yellow
- \* Tim Holtz mini blending, bone folder
- \* Pens, alcohol markers
- \* Sequins, stars
- \* Stickles Crystal glitter glue

## Pretty Posies

**1** Make a white blank, 11cm x 14cm, and apply distress inks in Spun Sugar and Shaded Lilac. Blend Festive Berries through a Wander & Find stencil. Following the step-by-step, die-cut a slot in the centre of the panel and the pull tab elements from white. Place the slider mechanism through the slot and fold into place, then trim to size. Adhere the top pull tab, then the holder to the reverse, to secure the slider.

**2** Line up and die-cut a notch from the top of the background and repeat with the blank. Stamp stars onto the background in purple ink. Trim white card to 11cm wide and cut a curve from the top edge. Apply green distress ink, then fix to the bottom of the card with foam pads. Stamp a fairy and flowers onto white, colour with marker pens and trim. Attach to the blank.

**3** Fix the fairy to the slider mechanism. Layer flowers on the mound of grass, and more behind it. Stamp a banner, colour with marker pens, then stamp a sentiment and cut out. Attach to the greeting using foam pads. Apply glitter glue to the fairy's wand and add star sequins to finish.



## Green Shoots

**1** Create a side-folding white blank, 11cm x 14cm. Trim white card, 11cm x 14cm, and blend on light blue and pink inks. Stamp yellow stars. Snip green card to 11cm wide, then die-cut three flower borders of different height. Blend green ink on the bottoms of the grass verges, then the flowers in yellow, purple and pink.

**2** Cut a narrow slot into the white card for the slider. Line up and cut another slot from the bottom layer of green, then fix to the panel. Die-cut the tab elements from green. Place the slider mechanism through the slot and fold into place, then trim. Secure the top pull tab and the

holder on the reverse to secure the slider. Line up and die-cut a notch from the top of the background, then repeat with the blank. Attach the section to the greeting.

**3** Stamp a sentiment onto the second layer of green, then fix to the background with foam pads. Adhere the third layer onto the bottom. Stamp the motifs onto white card, then colour with marker pens and cut out. Fix the flowers onto the front of the slider. Line up the wheelbarrow among the flowers, then secure the bottom edges. Stick on the fairy using foam pads. Add glitter glue to the stars, wings and the centre of the flowers.

## Craft smart

Use thick card for the mechanism – that'll make sure it stands up to lots of pulling in and out

# STEP-BY-STEP Slider cards



**1** Create a slot in the centre of the slider with a knife or die, then a notch at the top in line with it.

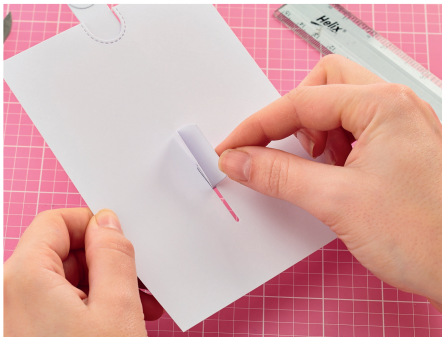

**2** Die-cut a slider mechanism, pull tab and its components. Fold and place through the slot.



**3** Stamp a fairy and flowers onto white card, colour and cut out.



**4** Attach the fairy to the slider mechanism and layer flowers on the grass mound to hide the fairy when the slider is down.



## Fairy Tales

**1** Create a white blank, 11cm x 14cm. Trim patterned paper, 11cm x 14cm, then fix to the blank. Trim white card to 14cm wide and die-cut a grassy border edge, applying green distress inks to it. Stamp on flowers with green, then colour in.

**2** Die-cut a slot in the centre of the grassy border. Die-cut a slider mechanism from white card, push through the slot, fold into place and trim the end to a point. Fix the holder

to the reverse. Adhere the grassy border to the bottom of the card using foam pads.

**3** Stamp all the decorative elements, then colour with marker pens and cut out. Print the sentiment onto the banner. Fix the fairy to the left edge of the slider, then add the present. Attach the house with foam pads around the top, bottom and right edges, hiding the fairy. Fix on the sentiment banner, then finish with the mushrooms and flowers. **(f)**



Claire says...

“Don’t worry if your paint washes are uneven, this will add interest and realism to the finished effect”

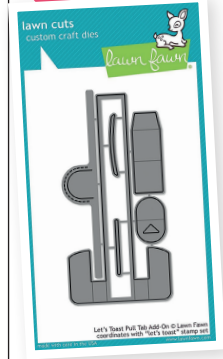

**EASY CUTS**  
Create instant slider tabs with Lawn Fawn’s die set, Let’s Toast Pull Tab Add-On, £10.87, [amazon.co.uk](http://amazon.co.uk)



**FAIRY FRIENDS**  
These character stamps are ideal for any occasion, visit [lawnfawn.com](http://lawnfawn.com) for stockists